



4 Fumina Court Morwell VIC

4 2 2

Tucked away in a quiet court in Morwell, this fresh and flawlessly presented home delivers the perfect balance of privacy, premium upgrades and family focused design.

Immaculate from front to back, it's a residence where every detail has been thoughtfully considered, simply move in and enjoy.

Property Features:

- From the moment you step inside, the quality is evident. Sunlight streams through striking three panel windows into the elegant formal lounge, where semi vaulted ceilings create a beautiful sense of height and space. Warm vinyl plank flooring underfoot and a built in bar set the tone for relaxed evenings and effortless entertaining.

[For full version visit the website](http://www.oneagencylv.com.au)

Type : House
Price : \$ 710,000
Land Size : 813 sqm
View : <http://www.oneagencylv.com.au/sale/vic/gippsland/morwell/residential/house/8586035>



Brett Chapman
03 5174 2740



Josh Quigley
03 5174 2740



This plan is not to scale.
 All measurements are approximate & individuals should rely on their own information.

ONE AGENCY
 LATROBE VALLEY

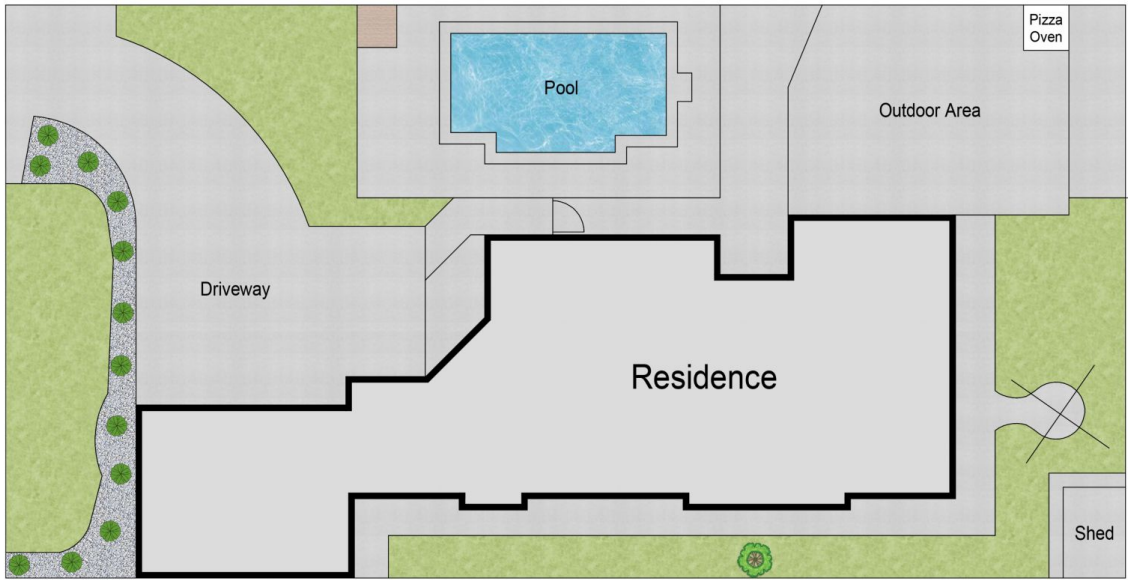

This plan is not to scale.
All measurements are approximate & individuals should rely on their own information.

ONE AGENCY
LATROBE VALLEY