

ONE

Sorry, I'm Under Application



ONE AGENCY
LATROBE VALLEY



6 Firmin Street Traralgon VIC

3 2 2

This well-designed three-bedroom family home offers a bright and inviting entry, leading to the spacious living, dining and kitchen areas. With the added benefits of a great shed, double enclosed carport and separate workshop to secure your tools, this great home will also appeal to a tradie or home handyman!

- Spacious living room flows into the kitchen dining area has split system, gas central heating & ceiling fan for all year comfort
- Kitchen boasts generous timber benchtops, stylish cabinetry, gas cooktop, oven, and dishwasher. A plumbed fridge cavity, plus large pantry with ample storage
- The adjoining laundry has excellent bench space, overhead storage, and direct access to the backyard and

Type : House
Land Size : 760 sqm
View : <http://www.oneagencylv.com.au/lease/vic/gippsland/traralgon/residential/house/8597998>



Cindy Visser
03 5174 2740



Linda McGann
03 5174 2740

[For full version visit the website](http://www.oneagencylv.com.au)

<http://www.oneagencylv.com.au>

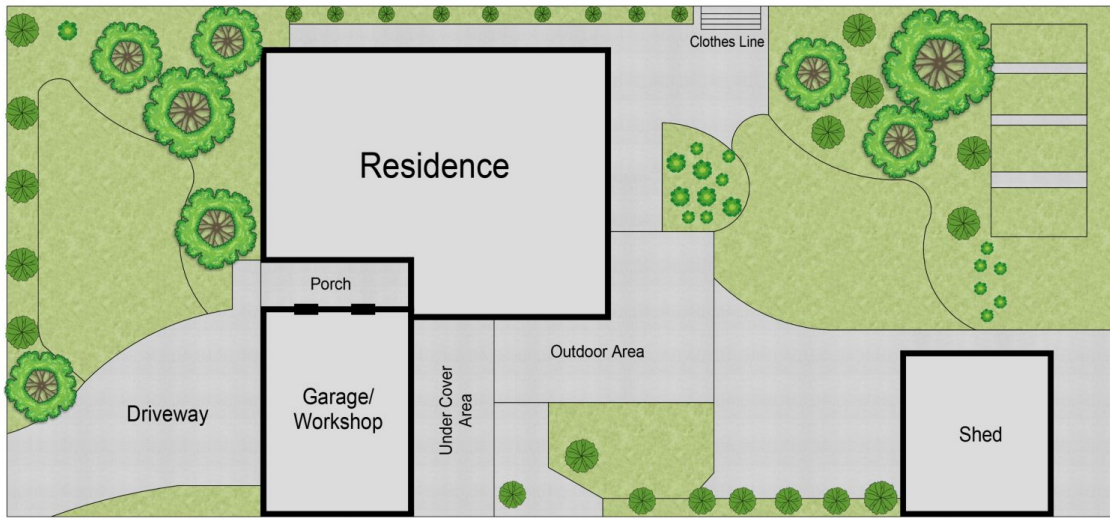

This plan is not to scale.
All measurements are approximate & individuals should rely on their own information.

ONE AGENCY
LATROBE VALLEY

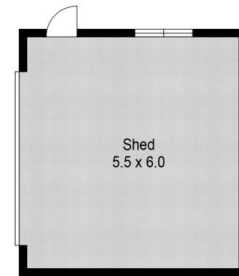

This plan is not to scale.
 All measurements are approximate & individuals should rely on their own information.

ONE AGENCY
 LATROBE VALLEY