



10 Angela Court Morwell VIC

4  2  6 

One Agency Latrobe Valley is proud to present 10 Angela Court, Morwell. This stunning 4-bedroom, brick veneer quality-built home is situated in a family friendly court location on a massive 1204m² allotment (approx.) and will tick all of the boxes for its new owners to simply move in and enjoy.

This property has a practical and functional floor plan offering two living zones including a great family room plus a separate lounge / theatre room at the front of the home. Each of 3 kids bedrooms include built in robes and are serviced by a fantastic family bathroom that features a walk in shower and spa bath while a large walk-in robe provides ample storage in the master suite which is also inclusive of a practical ensuite. The beautiful, impressive kitchen offers quality appliances, walk in pantry, a huge amount of bench space and interacts effortlessly to the dining, study nook,

Price : \$ 795,000
Land Size : 1204 sqm
View : <https://www.oneagencylv.com.au/sale/vic/gippsland/morwell/residential/house/6861380>



Anthony Bloomfield
03 5174 2740



Siobhan McNulty
0474 476 355

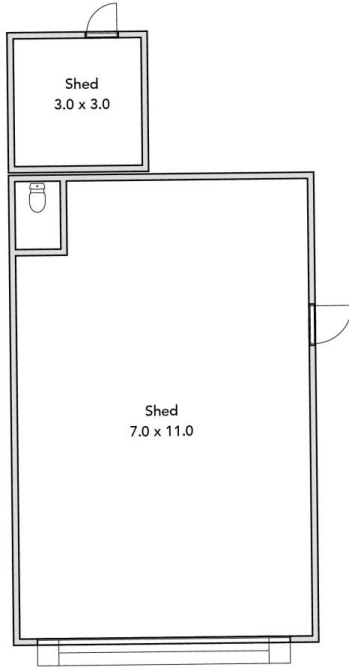
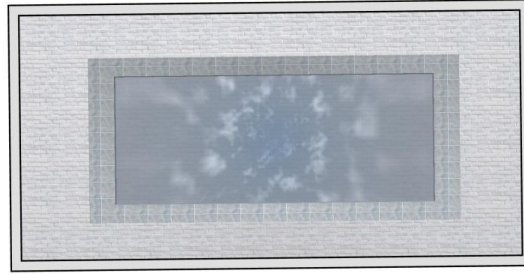
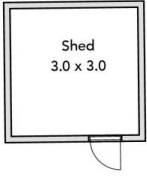

ONE AGENCY

LATROBE VALLEY

